

REV.	SPECIFICATION	ECN NO.	APPD.

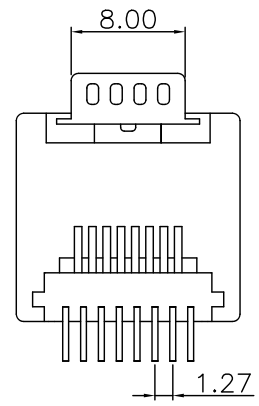
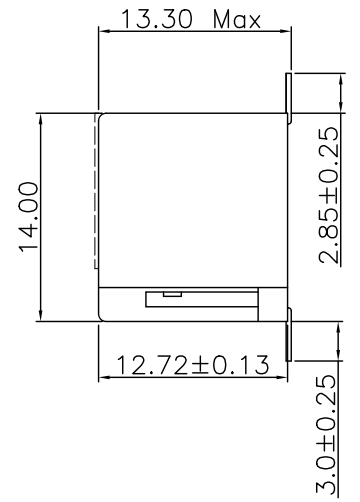
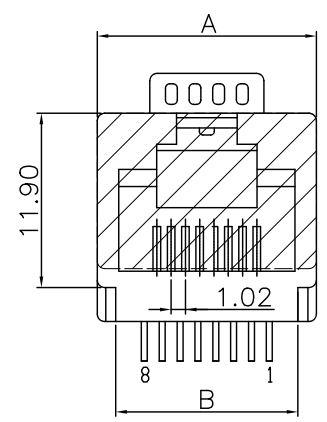

Material:

Housing: PA9T,UL94V-0.
 Contacts: Phosphor Bronze,Gold Plated on Contact Area and Gold Flash on solder tail over Nickel 50μ".
 Solder Pad: Brass.

Electrical Characteristics:

Voltage Rating: AC 150V.
 Current Rating: 1.5 AMP.
 Dielectric Withstanding Voltage: 1000V for 1 minute.
 Insulator Resistance: 500MΩ min. at DC 500V.
 Contact Resistance: 30mΩ max. at DC 100mA.
 Operating Temperature: -40°C~+85°C.

Mechanical Characteristics:

Mating Force: 2.3 kgf max.
 Durability: 750 Cycles.

***RoHS Compliant**

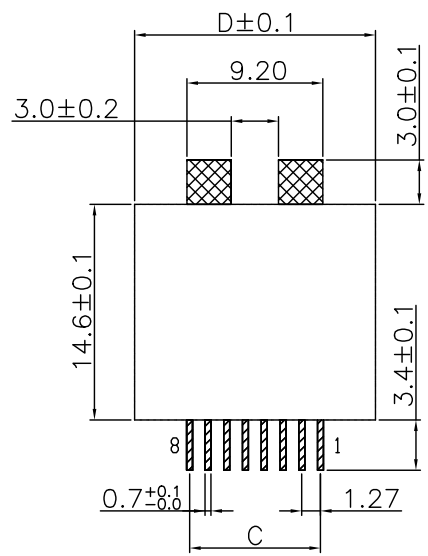

P.C. Board Layout

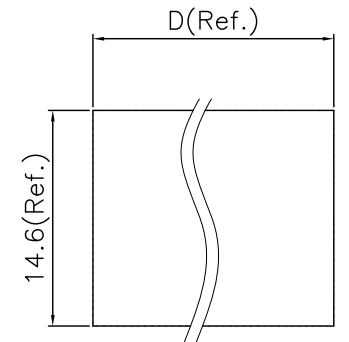

RECOMMENDED PANEL CUTOUT

8949-H4D	x	x	-06	B	N	A	-P
Series	8: 8 Position	8: 8 Contacts	06: 6μ" Gold Plated	B: Black	N: W/O Flange	A: Tray Package	Black: W/O Pad
	6: 6 Position	6: 6 Contacts	15: 15μ" Gold Plated			T: Tape & Reel Package	P: Plastic Pad
	4: 4 Position	4: 4 Contacts	30: 30μ" Gold Plated				
			50: 50μ" Gold Plated				

Position	Dimension			
	A	B	C	D
8	15.5	13.20	8.89	16.1
6	13.2	10.60	6.35	13.7
4	11.1	8.80	3.81	11.7

Tolerances	Dwg No.	8949D02058	Title:
x = ±0.5	Projection		8949-H4D Series Top Enrty SMD Type CAT5e
.x = ±0.25	Unit	mm	
.xx = ±0.15	Scale	1:1	
	Drawn By	Doris 06/12'18	①563

OUPIN
 OUPIN ELECTRONIC(KUNSHAN) CO., LTD.
 P/N: 8949-H4Dxx-06BNA-P
 SHEET 1/1 Ver.No. B1